

DO NOT SCALE

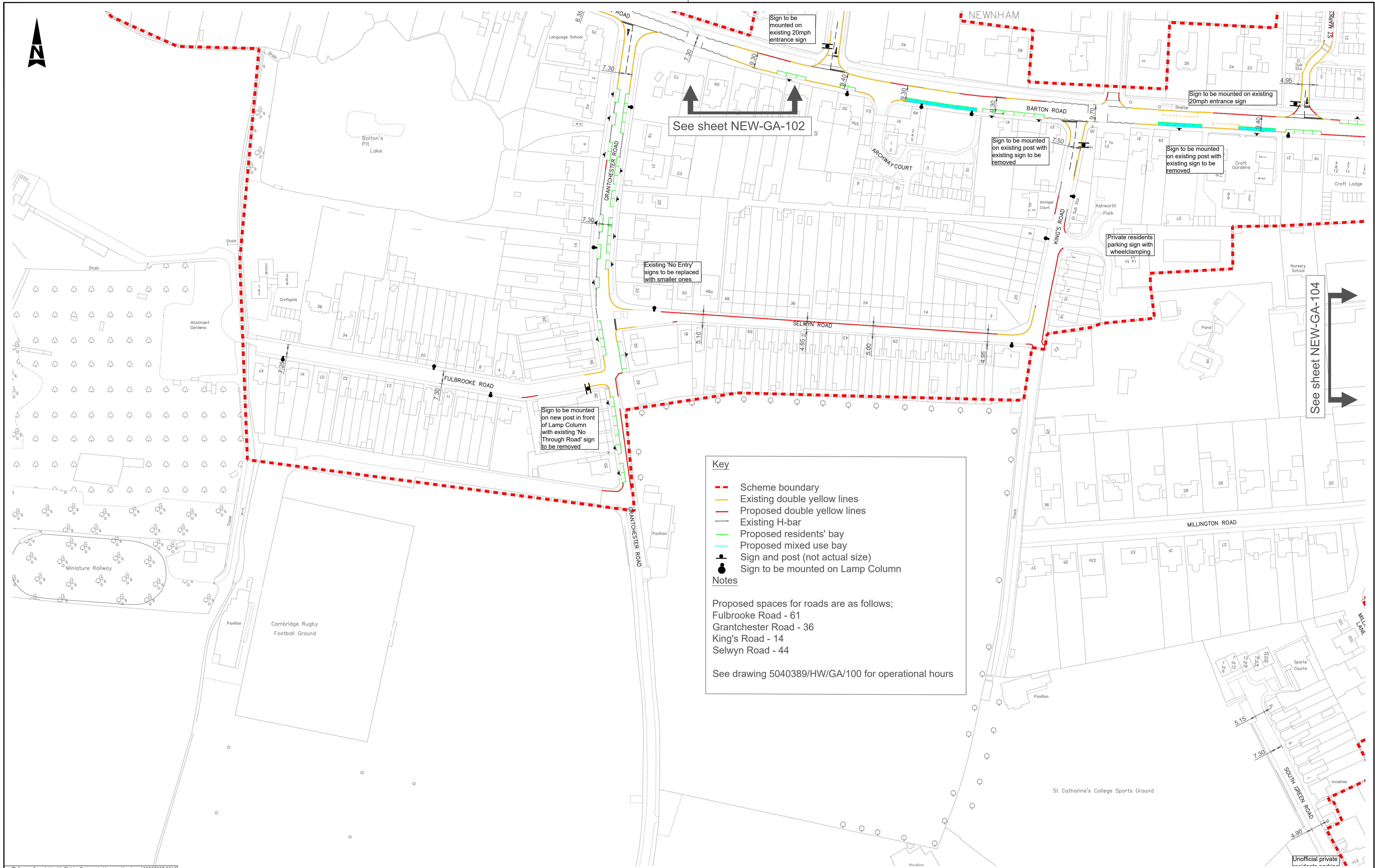

**Key**

- Scheme boundary
- Existing double yellow lines
- Proposed double yellow lines
- Existing H-bar
- Proposed residents' bay
- Proposed mixed use bay
- Sign and post (not actual size)
- Sign to be mounted on Lamp Column

**Notes**

Proposed spaces for roads are as follows;  
 Fulbrooke Road - 61  
 Grantchester Road - 36  
 King's Road - 14  
 Selwyn Road - 44

See drawing 5040389/HW/GA/100 for operational hours

©Crown Copyright. All Rights Reserved. License Number 100023205.2016

SAFETY, HEALTH AND ENVIRONMENTAL INFORMATION	
IN ADDITION TO THE HAZARDS/RISKS NORMALLY ASSOCIATED WITH THE TYPES OF WORK DETAILED ON THIS DRAWING, NOTE THE FOLLOWING SIGNIFICANT RESIDUAL RISKS	
CONSTRUCTION	(ENTER 'NONE' IF APPLICABLE)
MAINTENANCE/CLEANING	(ENTER 'NONE' IF APPLICABLE)
USE	(ENTER 'NONE' IF APPLICABLE)
DECOMMISSIONING/DEMOLITION	(ENTER 'NONE' IF APPLICABLE)

Rev	Description	By	Date	Chk'd	Auth	Rev	Date	Auth	Purpose of Issue
H	Amendment to operation hours	NT	06/18			O	07/19		Minor Amendments
G	Amendment to drop kerbs from applications	NT	05/18			N	05/19		Minor Amendments
F	Marks Court amended to 7 bays within key	GB	05/18			M	05/19		Changes after meeting
E	Amended to operational hours & locations of signs	NT	05/18			L	12/18		Changes after meeting
D	Amended after site review	NT	03/18			K	10/18		Changes to signage
C	Final amendments	NT	01/18	B-H	B-H	J	09/18		Changes to signage
B	After main stakeholders' meeting	NT	07/17	B-H	B-H	I	08/18		Changes to signage
A	After councillors' meeting	B-H	07/17	B-H	B-H				

Client

working for

Cambridgeshire Highways

5 Wellbrook Court  
 Girton Road  
 Cambridge CB3 0NA  
 cambridgeshirehighways@skanska.co.uk

Tel: (01223) 814400

Project  
**Newnham Craft Residential Parking Scheme**

Title <b>Proposed Signing and Lining Sheet 3 of 4</b>	
Original Scale <b>1:2,000</b>	Designed/Drawn NT
Checked AJB-H	Authorised AJB-H
Date 05/12/16	Date 05/10/17
Date 05/10/17	Date 05/10/17
Status C	Drawing Number NEW/GA/103
Rev O	